

ANY PANEL. ANY SITE. ONE COMMUNICATOR



Open up a world of opportunities

The all new **SmartCom Pro** communicator range is designed specifically for alarm signalling from other manufacturers panels. Whether it's a new installation or an upgrade to a current system, the SmartCom Pro range provides a gateway to primary alarm communications with your chosen alarm receiving centre (ARC) regardless of the intruder panel fitted.

Open up the opportunities Texecom digital services provide. SmartCom Pro is the gateway to Texecom Cloud and beyond.



Unlock the
benefits



Texecom

NOW EVEN SMARTER

Features & Benefits:

- **Versatile Connectivity:** Supports both Ethernet and Wi-Fi, allowing for flexible installation in various environments. (Pro/Pro 4G only)
- **Untethered Redundant Data Connectivity:** 2 modems, 2 MNO's, 3 roaming SIM's connects to 2 separate networks. Maximising redundancy and minimising installation effort. (Pro DR only)
- **Customisable Alarm Signalling:** 10 configurable input PINS enable tailored alarm configurations for diverse event signalling needs.
- **Flexibility in Applications:** 4 configurable outputs ensure adaptability for different applications.
- **Broad Power Supply Range:** Operates efficiently on 11 to 30V, suitable for use on security or fire systems.
- **Seamless Integration:** Full serial compatibility with Texecom Premier Elite systems.
- **Universal Compatibility:** Can be used with any panel with digital outputs, enhancing its versatility.

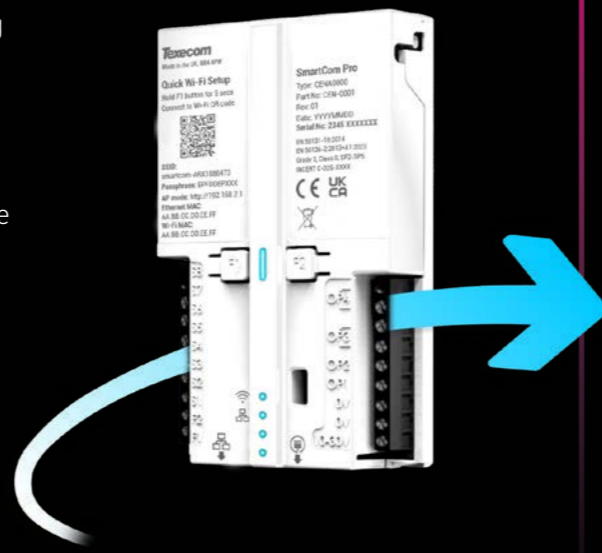

The **smarter choice** for your alarm signalling

The **SmartCom Pro range** offers three versatile options for seamless alarm signalling: **SmartCom Pro** (single path) connects any intruder panel via Wi-Fi or ethernet; **SmartCom Pro 4G** (dual path) ensures reliable communication with enhanced 4G connectivity; and **SmartCom Pro DR** (dual radio) provides a dual redundant solution by selecting the two best available 4G networks for maximum stability.

SmartCom Pro

Single Path Communicator
Ethernet or Wi-Fi
SP2



SmartCom Pro 4G

Dual Path Communicator
Ethernet or Wi-Fi / 4G
SP2 (4G), DP1 - DP4



SmartCom Pro DR

Dual Radio 4G Communicator
DP2 or DP3



The gateway to our digital services

Seamlessly integrate and enhance security with Texecom's digital services - Texecom Connect, Texecom Cloud, and Texecom Monitor. **Texecom Connect** gives users full control of their security system via a simple app, with remote arming, disarming, and real-time alerts. **Texecom Cloud** allows installers to manage and update systems remotely, reducing site visits and improving efficiency. **Texecom Monitor** ensures fast, reliable alarm signalling to an Alarm Receiving Centre (ARC) for a quick response.



End user app
management



Automated remote
servicing



EN 50136 compliant
connection to leading ARCs



SmartCom Pro



Single Path Communicator compatible with any intruder panel

SmartCom Pro is an intelligent communicator designed to connect any manufacturer's panel with digital outputs for alarm signalling via Texecom Monitor. When used with Texecom Premier Elite systems, it unlocks the full suite of digital services; Texecom Connect, Texecom Cloud, and Texecom Monitor. Opening up the benefits of Texecom Digital Services has never been easier with quick and easy operation via either a WiFi or hardwired ethernet connection.

- **Universal Compatibility:** Works with any intruder panel (with output trigger pins).
- **Flexible Connectivity:** Supports Wi-Fi and Ethernet.
- **Quick Setup:** Easy Wi-Fi setup via QR code and local Wi-Fi AP mode.
- **Customisable:** 10 configurable input PINS and 4 outputs.
- **Secure:** AES 256 encryption and anti-substitution protection.
- **Texecom Integration:** Full compatibility with Premier Elite panels providing health checks, configuration, and updates via Texecom Cloud.
- **Transmission Category:** SP2



Specifications

Signalling details:

- IP signalling over customers broadband or network
- Continuously polled IP path
- Wi-Fi 802.11 b/g/n 2.4GHz
- Quick Wi-Fi set-up via QR code connection to AP Mode
- Supports WPA, WPA2
- Alarm messages and polling are highly encrypted using AES 256 encryption
- Software anti-substitution protection
- Alarm signalling to all major ARCs via Texecom Monitor

System site configuration (UDL):

- Texecom Premier Elite panels

Management features:

- Remote health checks, configuration and fault diagnosis via Texecom Cloud
- Firmware upgrade via Texecom Cloud
- Annual connection / service billing via Texecom Cloud

Alarm panel interfaces:

- 10 Standardised parallel interface inputs
- EOL tamper protected link to detect fault if cable disconnected
- 4 outputs: 2 x open collector and 2 x relay
- Configurable outputs:
 - Open/Close keyswitch operation
 - ATP Fault
 - ATS Fault
 - SmartCom tamper

Power specifications:

- Nominal 12V / 24V (dc) (10V to 30V dc)
- Typical Current: 95mA @ 12V dc
- Peak: 150mA @ 12V dc

Configuration:

- 4 step LED indication simplifies commissioning
- Automatic connection to Texecom Cloud
- Local WiFi AP mode to configure and view WiFi status

Compliance:

- PD 6669 : 2017
- EN 50131-1: +A3:2020, EN 50131-10: 2014
- EN 50136-1: 2012+A1:2018
- EN 50136-2: 2013+A1:2023
- Transmission category: SP2 to SP5
- Environmental Class II

About the unit:

- Operating temperature: 0°C to 40°C
- Relative humidity: 0% to 95% non-condensing
- Part Code: CEN-0001



Warranty:

- 2 years

Unit comes with:

- Premier Elite panel cable for proprietary serial connection

Dimensions & Weight

SmartCom Pro module

Dimensions: 75mm(w)120mm(h)26mm(d) Weight: 119g

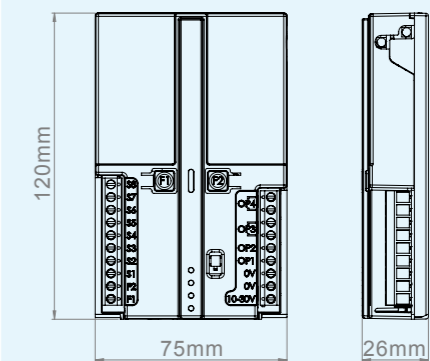

SmartCom Pro case

(Available separately, Part code: JAQ-0007)

Dimensions: 126mm(w)180mm(h)35mm(d) Weight: 200g

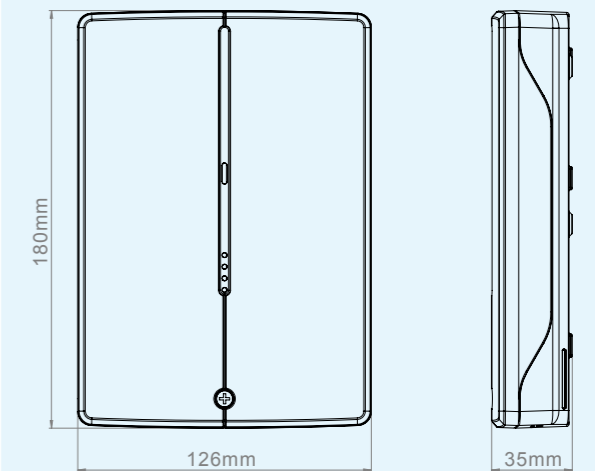

Texecom Monitor is available in the UK, Belgium, Netherlands and Luxembourg. Contact cloud@texe.com for support in other regions.

SmartCom Pro

SmartCom Pro 4G



Dual Path Communicator compatible with any intruder panel

Take your next security installation to a higher level with the enhanced SmartCom Pro 4G Communicator – the advanced gateway communication device for alarm signalling from any manufacturers panel with digital outputs. Boasting enhanced connectivity across all 4G bands the new Smartcom Pro 4G is the ideal communicator no matter the location.

- **Enhanced Reliability:** Dual path communication ensures continuous operation, switching automatically from primary path Ethernet to 4G back up if the primary path fails.
- **Improved Signal Performance:** Enhanced 4G signal strength ensures reliable communication where 2G or 4G networks coverage is available.
- **Advanced Security:** Roaming eSIMs on Texecom's private APN provide enhanced data security, reducing risks of SIM or signal interception
- **Multi-Profile SIMs:** Offers triple-layer protection for dual-path LAN/Radio or dual-radio configurations.
- **Texecom Integration:** Full compatibility with Premier Elite panels providing health checks, configuration, and updates via Texecom Cloud.
- **Transmission Category:** SP2 or DP1 - DP4



Specifications

Data connectivity:

- On network / data path failure - reconnects to an alternative network
- eUICC Multi profile SIM technology provides 2 World roaming SIM's in one product. Protects against MNO backbone failure

Signalling details:

- LTE Bands: B1, B3, B7, B8, B20, B28A
- Alarm messages and polling are highly encrypted using AES 256 encryption
- Software anti-substitution protection

System site configuration (UDL):

- Texecom Premier Elite panels

Management features:

- Remote health checks, configuration and fault diagnosis via Texecom Cloud
- Firmware upgrade via Texecom Cloud
- Annual connection / service billing via Texecom Cloud

Alarm panel interfaces:

- 10 Standardised parallel interface inputs
- EOL tamper protected link to detect fault if cable disconnected
- 4 outputs: 2 x open collector and 2 x relay
- Configurable outputs:
 - Open/Close keyswitch operation
 - ATP Fault
 - ATS Fault
 - SmartCom tamper

Power specifications:

- Operating Voltage, 10 - 30 Vdc
- Typical Current, 120mA @ 12V dc
- Peak, 450mA @ 12V dc

Configuration:

- 4 step LED indication simplifies commissioning
- Automatic connection to Texecom Cloud
- Local WiFi AP mode to configure and view WiFi status

Compliance:

- PD 6669 : 2017
- EN 50131-1: +A3:2020, EN 50131-10: 2014
- EN 50136-1: 2012+A1:2018
- EN 50136-2: 2013+A1:2023
- Transmission category: SP2 or DP1 - DP4
- Environmental Class II

Supported Regions:

- 4G Signalling: UK, Europe, India and South Africa

Texecom Monitor is available in the UK, Belgium, Netherlands and Luxembourg. Contact cloud@texe.com for support in other regions.

About the unit:

- High performance 4G antenna included with MMCX connector
- Operating temperature: 0°C to 40°C
- Relative humidity: 0% to 95% non-condensing
- Part code: CEP-0001



Warranty:

- 2 years

Unit comes with:

- High performance 4G antenna
- Premier Elite panel cable for proprietary serial connection

Dimensions & Weight

SmartCom Pro module

Dimensions: 75mm(w)120mm(h)26mm(d) Weight: 119g

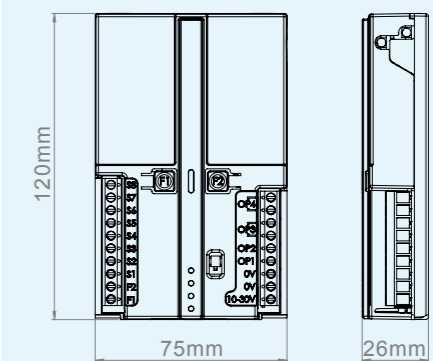

SmartCom Pro case

(Available separately, Part code: JAQ-0007)

Dimensions: 126mm(w)180mm(h)35mm(d) Weight: 200g

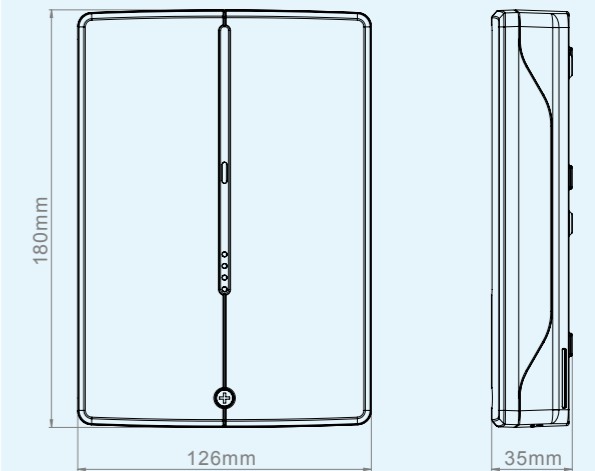

SmartCom Pro 4G

SmartCom Pro DR

Specifications



Dual Radio 4G Communicator compatible with any intruder panel

SmartCom Pro DR benefits from dual radio communications ensuring it intelligently selects the two best network operators available in that area for alarm signalling. Enjoy peace of mind with a dual redundant solution that uses the best available 4G radio signals to ensure a stable connection in most locations.

- **Dual Path Communication (Radio/Radio):** Ensures reliable and redundant communication to ensure alarms are signalled and systems are available.
- **Improved Signal Performance:** Enhanced 4G signal strength ensures reliable communication where 2G or 4G networks coverage is available.
- **Enhanced Data Security:** Dual roaming eSIM's from separate mobile network operators on Texecom's private APN with encrypted signalling.
- **Multi-Profile SIMs:** Offers triple layer protection for Dual Radio configurations, effectively providing virtual back up SIM's.
- **Texecom Integration:** Full compatibility with Premier Elite panels providing health checks, configuration, and updates via Texecom Cloud.
- **Transmission Category:** DP2 or DP3



About the unit:

- High performance 4G antenna included with MMCX connector
- Operating temperature: 0°C to 40°C
- Relative humidity: 0% to 95% non-condensing
- Part code: CEQ-0001



Warranty:

- 2 years

Unit comes with:

- 2 High performance 4G antennas
- Premier Elite panel cable for proprietary serial connection

Data connectivity:

- On network/data path failure - reconnects to alternative network
- Dual modem with dual roaming SIM's from separate network operators.
SIM 1 - World OV eUICC Multi profile SIM technology enables selection of Vodafone or Manx Telecom roaming profile
SIM 2 - Telefonica O2 roaming SIM

Signalling details:

- LTE Bands: B1, B3, B7, B8, B20, B28A
- Alarm messages and polling are highly encrypted using AES 256 encryption
- Software anti-substitution protection

Note: Dual path supported on Dual Radio only - LAN and WiFi are not supported as signalling channels

System site configuration (UDL):

- Texecom Premier Elite panels

Management features:

- Remote health checks, configuration and fault diagnosis via Texecom Cloud
- Firmware upgrade via Texecom Cloud
- Annual connection / service billing via Texecom Cloud

Alarm panel interfaces:

- 10 Standardised parallel interface inputs
- EOL tamper protected link to detect fault if cable disconnected
- 4 outputs: 2 x open collector and 2 x relay
- Configurable outputs:
 - Open/Close keyswitch operation
 - ATP Fault
 - ATS Fault
 - SmartCom tamper

Power specifications:

- Operating Voltage, 10 - 30 Vdc
- Typical Current, 130mA @ 12V dc
- Peak, 550mA @ 12V dc

Configuration:

- 4 step LED indication simplifies commissioning
- Automatic connection to Texecom Cloud
- Local WiFi AP mode to configure product

Compliance:

- PD 6669 : 2017
- EN 50131-1: +A3:2020, EN 50131-10: 2014
- EN 50136-1: 2012+A1:2018
- EN 50136-2: 2013+A1:2023
- Transmission category: DP2 and DP3
- Environmental Class II

Supported Regions:

- 4G Signalling: UK, Europe, India and South Africa

Texecom Monitor is available in the UK, Belgium, Netherlands and Luxembourg. Contact cloud@texe.com for support in other regions.

Dimensions & Weight

SmartCom Pro DR module

Dimensions: 75mm(w)120mm(h)26mm(d) Weight: 119g

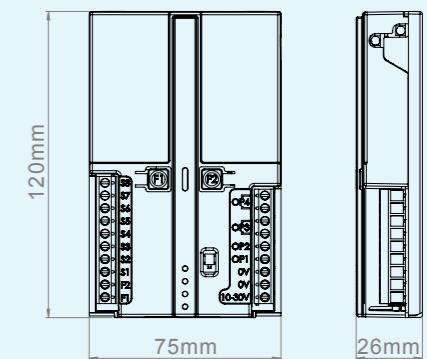

SmartCom Pro case

(Available separately, Part code: JAQ-0007)

Dimensions: 126mm(w)180mm(h)35mm(d) Weight: 200g

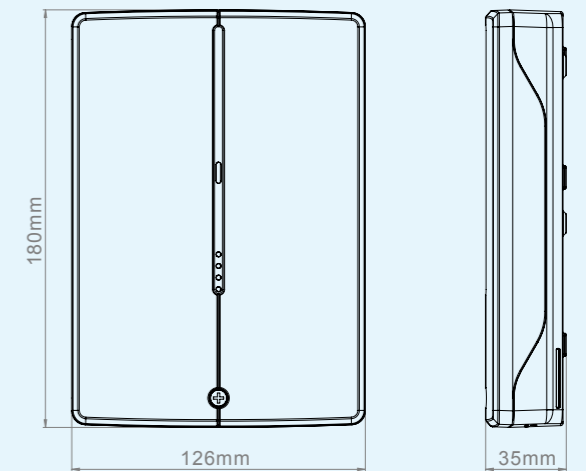

SmartCom Pro DR

FASTER. STRONGER. SMARTER



Part Codes

Product Name	Part Code	Description
SmartCom Pro	CEN-0001	SmartCom Pro module with Premier Elite or Pins input and Wi-Fi or LAN connection
SmartCom Pro 4G	CEP-0001	SmartCom Pro module with Premier Elite or Pins input and Wi-Fi or LAN & 4G connection
SmartCom Pro DR	CEQ-0001	SmartCom Pro module with Premier Elite or Pins input and Dual 4G
Accessories		
SmartCom Pro Case (Single)	JAQ-0007	EN50131 compliant housing for all SmartCom Pro products
SmartCom External Antenna	JAQ-0003	SmartCom/SmartCom Pro 4G/DR External Antenna with 10m cable and MMCX connector



Unlock the
benefits



Texecom